

**Seasonal Maintenance Guide for:**

- Blur LT - 2008 ( BLT.2 )
- Blur LT Carbon - 2009 ( BLT.2-C )
- Nomad -2008 ( Nomad.2 )

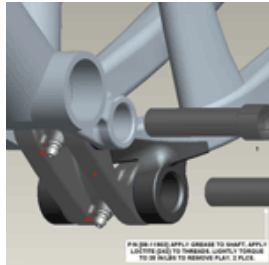

Click to Enlarge



Click to Enlarge



Click to Enlarge

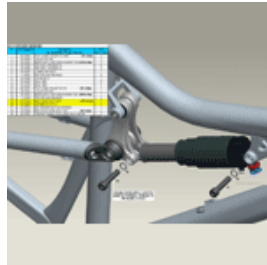

Click to Enlarge

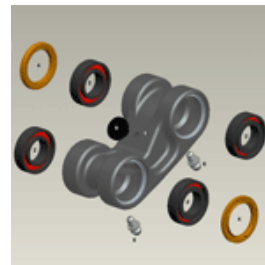

Click to Enlarge

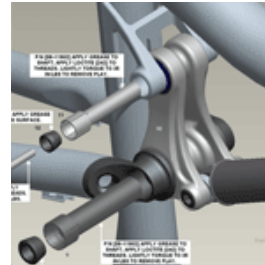

Click to Enlarge

**Tool Required**

- Metric Allen wrench set
- torque wrench
- SCB grease gun (included with frame)

**Step 1:** Check Bolts for Proper Torque

- a) Use a torque wrench to check that all bolts are properly tightened.  
M6 wedge bolts 110 in/lbs  
(lower link bolts plus the seatstay pivot bolt)  
M5 wedge bolt 100 in/lbs  
(upper pivot in the upper link)  
Shock mounting bolts 190 in/lbs  
Derailleur hanger bolts 80in/lbs  
(Fig. 1)
- b) If any of the wedge bolts are loose, remove them and pry the tapered washer out.
- c) Use an 8mm or 5mm allen wrench (on the uppermost axle) to check torque on the pivot axle. It should be just snugged up, or 35 in/lbs.
- d) Grease the external surface of the tapered washer, and apply Loctite 242 to the bolt threads.
- e) Tighten the wedge bolt to the proper torque (see step a)



Fig. 1

**Step 2:** Replace Grease in Lower Link

- a) Follow the instructions included in the grease gun package to load a grease cartridge into the gun. Squeeze the trigger until you get a consistent flow with no air pockets.

- b) Use a 9/16" or adjustable wrench and some pliers to loosen the nozzle on the gun. Hold the nut stationary and loosen the knurled cap with pliers. A vice with axle clamps also works to hold the knurled cap. (Fig. 2)



Fig. 2

- c) Don't loosen the cap too much, just enough where you can press the gun onto the grease fittings on your lower link.
- d) Once it pops onto the fitting, tighten the knurled cap down so the gun grips the fitting. (Fig. 3 )
- e) Squeeze grease into the lower link until the grease coming out of the bearing seals is clean.
- f) Loosen the grease gun nozzle so the grease gun can be easily removed, and wipe off any excess grease.



Fig. 3